

ALES QUAD

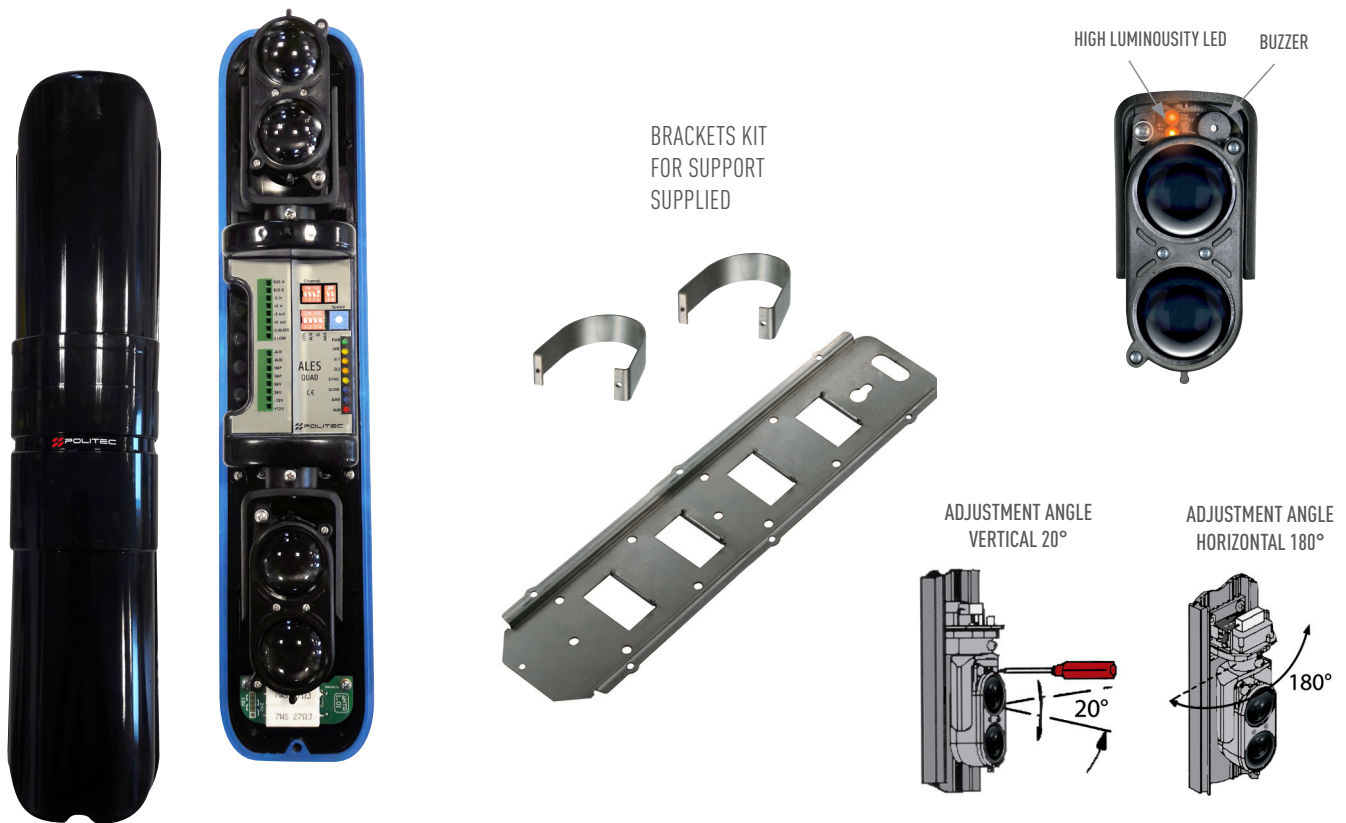

The small two, double beam barrier with long range

Ales Quad is a double range barrier with active infrared with 4 lenses with compact dimensions. Pre-wired and ready for installation, it is composed of a transmitter unit and a receiver. It is positioned in each corner and can be installed on poles or on walls. Resistant, compact and easy to install, it is the only barrier of its kind to have a 250 meter range.



Technical characteristics

Maximum use distance outdoors	160 m / 250 m
Maximum use distance indoors	500 m
Reach maximum distance	600 m
Double optical with double beam	35 mm lenses in AND
IR beams	Impulse rays in work wave 950 NM
Synchronisation	Optic with 4 channels - Wired
Pointing and alignment system	Optical-acoustic SMA technology
Beam arrangement	parallel
Walk-test function	YES
Configuration of beams in the tower in TERMINAL mode	2TX and 2RX
Circuit absorption	50 mA
Heaters power supply	10 - 30 Vcc
Thermostatic heaters absorption	10 - 15 Vcc 250 mA / 24 - 30 Vcc 125 mA
Alarm output	Relay with free contacts NC (on RX)
Tamper-proof output	Tamper opening lids
Fog environmental output	Yes with dedicated OC output
Level of protection	IP65
Dimensions H x D x W	400 x 85 x 82 mm